

Technical Data

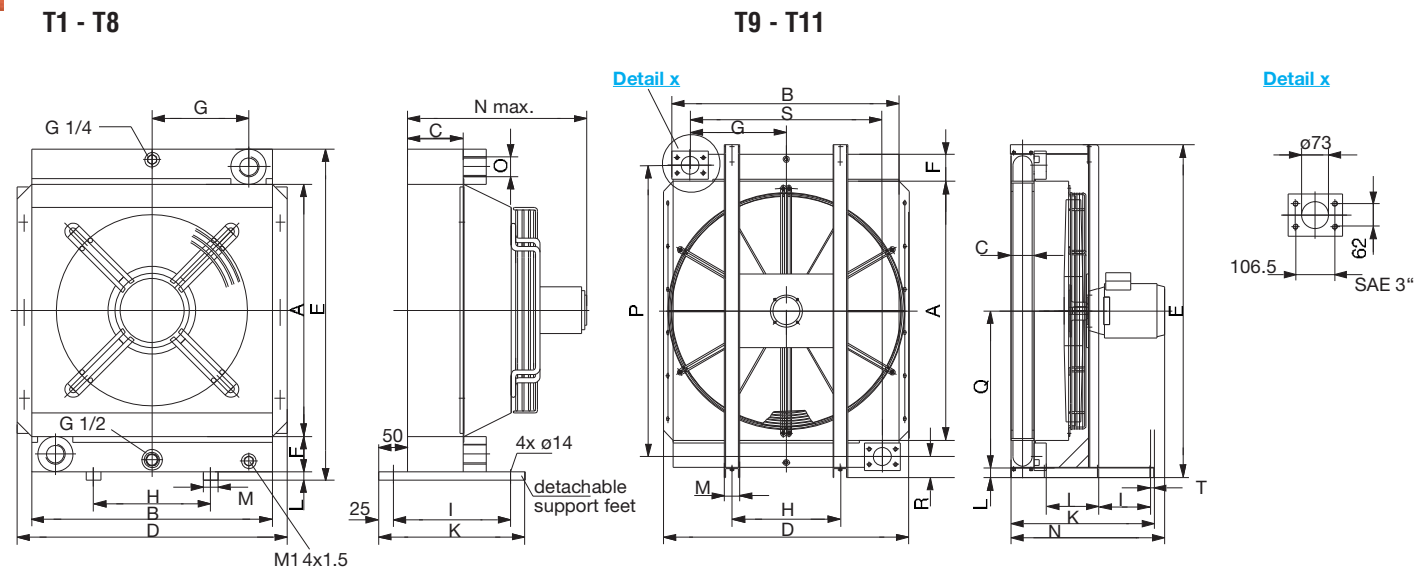

SPECIFICATION											
Cooler Type	T1	T2	T3	T4	T5 (T5K) ²⁾	T6	T7	T8	T9	T10	T11
Heat rejection ¹⁾	1-5	3-10	8-15	10-20	15-25	20-35	25-40	35-75	60-120	85-180	120-260

DIMENSIONS											
A	200	300	400	400	550	650	800	800	1050	1200	
B	191	302	396	396	411	557	557	651	915	1206	
C	63	63	63	94	94 (63)	94	94	140	94	113	140
D	248	355	451	451	466	607	608	722	995	1276	
E	315	415	515	535	690	790	940	960	1352	1520	
F	50	50	50	60	60	60	60	70	110	110	
G	65	115	160	160	165	235	235	280	390	532	
H	80	150	200	200	200	310	310	400	440	525	
I	150	200	200	250	250	250	250	250	215	210	
K	200	250	250	300	300	300	300	300	580	750	
L	15	15	15	15	20	20	20	20	40	50	
M	25	25	25	25	30	50	50	50	65	100	
N max.	175	370	400	430	440 (410)	ca. 450	ca. 450	ca. 590	ca. 650	ca. 790	ca. 900
O	1\"BSP	1\"BSP	1\"BSP	1 1/4\"BSP	1 1/4\"BSP (1\"BSP)	1 1/4\"BSP	1 1/4\"BSP	1 1/2\"BSP			
P									1182	1332	
Q									635	710	
R									91	94	
S									780	1064	
T									15	20	

(all dimensions in mm)

ORDER CODE SYSTEM

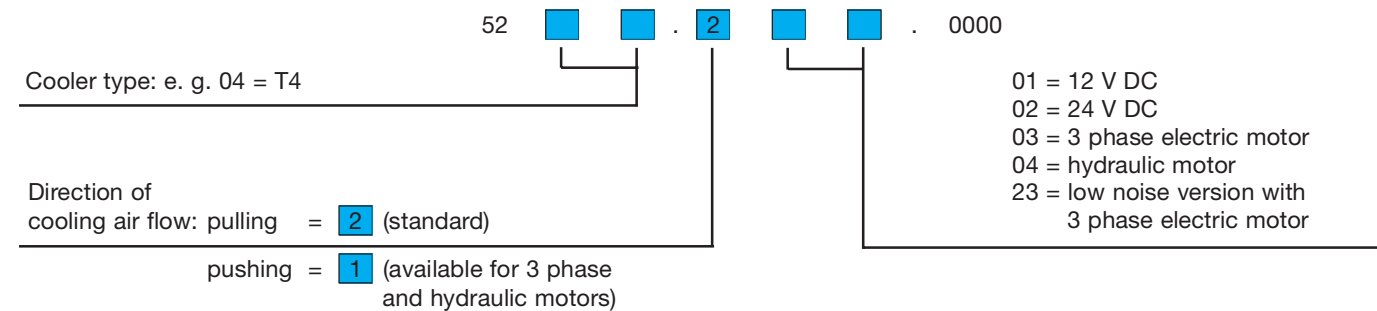

1) For details use diagrams and tables as appropriate

2) use T5K for low oil flows

All systems are pressure tested according to DIN 50104

Cooler Type	Order Number	Fan Diameter [mm]	Fan Speed [rpm]	Noise Level [dB(A), 1m]	Motor Voltage [V]	Power Consumption [kW]	Volume [l]	Working Pressure [bar]	Total Weight excluding fluid [kg]	
T1	5200.201.0000	167	3250	71	12	0.08	1.0	26	6.7	
	5200.202.0000	167	3250	71	24	0.08	1.0	26	6.7	
	5200.203.0000	170	2750	64	230/400	0.05	1.0	26	7.1	
T2	5202.201.0000	255	2600	74	12	0.15	1.9	26	15.6	
	5202.202.0000	255	2600	72	24	0.15	1.9	26	15.6	
	5202.203.0000	250	3000	75	230/400	0.25	1.9	26	15.6	
	5202.204.0000	250	3000	75	Hydraulic		1.9	26	15.6	
L	5202.223.0000	250	1500	57	230/400	0.18	1.9	26	15.6	
T3	5203.201.0000	350	2950	76	12	0.2	2.9	26	23	
	5203.202.0000	350	2950	78	24	0.25	2.9	26	23	
	5203.203.0000	380	1500	75	230/400	0.37	2.9	26	23	
	5203.204.0000	380	1500	75	Hydraulic		2.9	26	23	
	L	5203.223.0000	380	1000	68	230/400	0.25	2.9	26	23
T4	5204.201.0000	350	2950	77	12	0.2	5.2	26	28.8	
	5204.202.0000	350	2950	78	24	0.25	5.2	26	28.8	
	5204.203.0000	380	1500	77	230/400	0.37	5.2	26	28.8	
	5204.204.0000	380	1500	77	Hydraulic		5.2	26	28.8	
	L	5204.223.0000	380	1000	68	230/400	0.25	5.2	26	28.8
T5	5205.201.0000	385	3100	79	12	0.27	6.3	26	38	
	5205.202.0000	385	3100	79	24	0.24	6.3	26	38	
	5205.203.0000	450	1500	77	230/400	0.37	6.3	26	38	
	5205.204.0000	450	1500	77	Hydraulic		6.3	26	38	
	L	5205.223.0000	450	1000	68	230/400	0.25	6.3	26	38
K	5215.203.0000	450	1500	77	230/400	0.37	6.3	26	38	
T6	5206.201.0000	2 x 305	3100	81	12	2 x 0.27	9.4	26	49	
	5206.202.0000	2 x 305	3100	81	24	2 x 0.27	9.4	26	49	
	5206.203.0000	500	1500	79	230/400	0.55	9.4	26	49	
	5206.204.0000	500	1500	79	Hydraulic		9.4	26	49	
	L	5206.223.0000	500	1000	68	230/400	0.37	9.4	26	49
T7	5207.203.0000	500	1500	79	230/400	0.55	10.6	26	54	
	5207.204.0000	500	1500	79	Hydraulic		10.6	26	54	
	L	5207.223.0000	500	1000	68	230/400	0.37	10.6	26	54
T8	5208.203.0000	630	1000	79	230/400	1.1	17.7	26	89	
	5208.204.0000	630	1000	79	Hydraulic		17.7	26	89	
	L	5208.223.0000	630	750	68	230/400	0.55	17.7	26	89
	S	5208.231.0000	630	1500	90	230/400	2.2	17.7	26	89
T9	5209.203.0000	900	1000	88	230/400	2.2	25	10	190	
	5209.204.0000	900	1000	88	Hydraulic		25	10	190	
	L	5209.223.0000	900	750	82	230/400	1.5	25	10	190
T10	5210.203.0000	900	1500	98	400/690	5.5	31	10	200	
	5210.204.0000	900	1500	98	Hydraulic		31	10	200	
	L	5210.223.0000	900	1000	88	230/400	3.0	31	10	200
T11	5211.203.0000	1000	1500	100	400/690	11.0	55	10	ca. 290	
	5211.204.0000	1000	1500	100	Hydraulic		55	10	ca. 290	
	L	5211.223.0000	1000	1000	90	400/690	7.5	55	10	ca. 290

More details about fandrives on request.

3 phase electric motor: T2 - T9: B14, small flange, T10 - T11: B5 displacement [cm³] hydraulic motor: T2 - T8: 11 ccm, T9 - T10: 21 ccm

Materials

Cooler:	Aluminium
Fan blade:	Plastic
Fan shroud, finger guard, support feet, motor support flange:	Steel (Zinc plated), Painted/Powder coated